

This design or drawing is the sole property of Calamba Water District. No part of this design or drawing may be reproduced or transmitted in any form or by any means without the written consent of its owner.

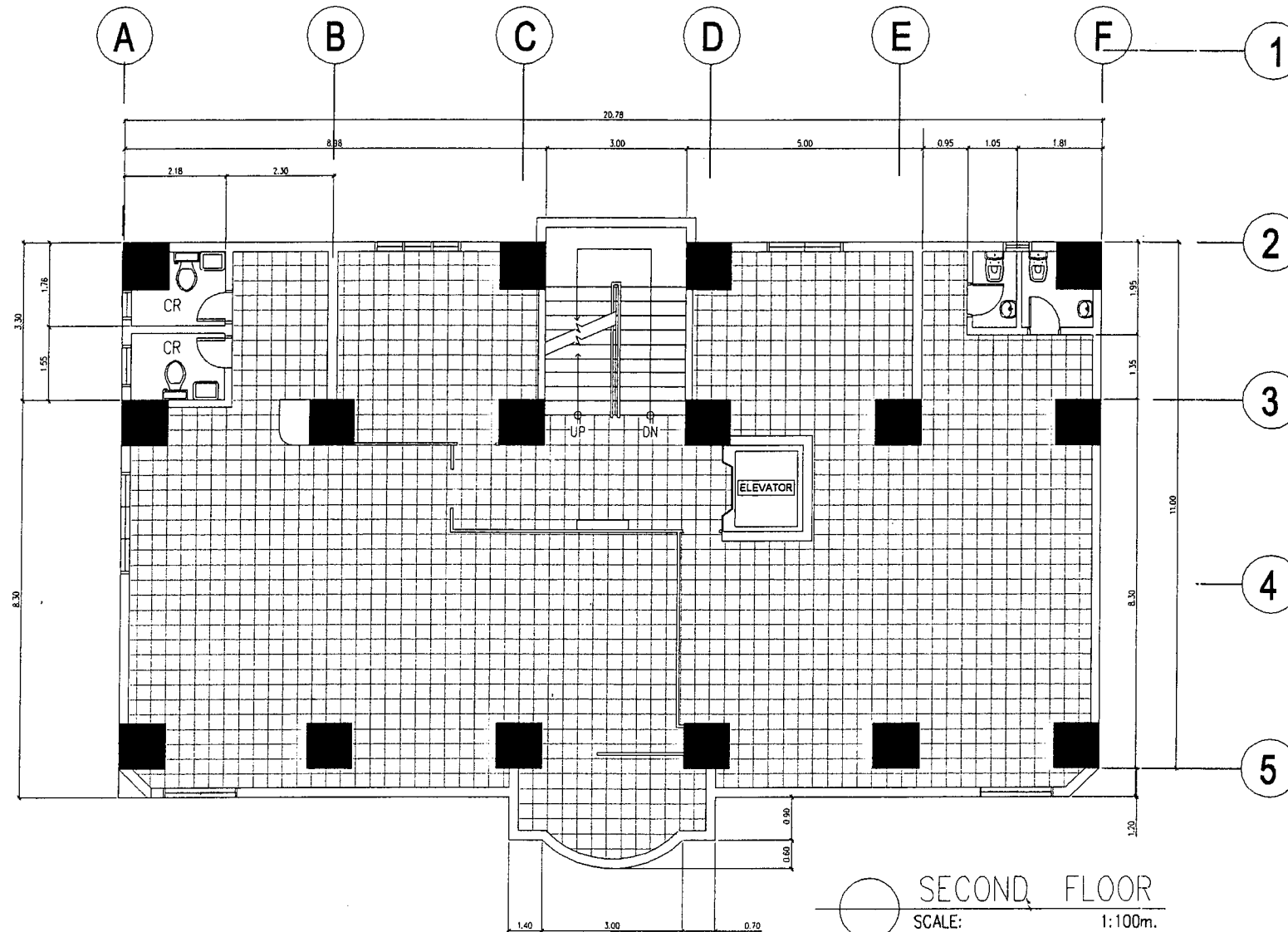

SECOND FLOOR
SCALE: 1:100m.

W CALAMBA WATER DISTRICT
ENGINEERING DEPARTMENT
PLANNING AND DESIGN DIVISION

LAKEVIEW SUBD., HALANG, CALAMBA CITY

PROJECT TITLE: PROPOSED RENOVATION OF DILAPIDATED FLOOR TILES AT CWD BUILDING

LOCATION:

DRAWN BY: A. L. DEL PRADO
DESIGNED BY: A. L. DEL PRADO
CHECKED BY: ENGR. J. GILLERA
APPROVED BY: MR. E. A. AGUILAR JR.

SHEET CONTENTS:

DATE: 07/24/2020

SHEET NO.

A-1

This design or drawing is the sole property of Calamba Water District. No part of this design or drawing may be reproduced or transmitted in any form or by any means without the written consent of its owner.

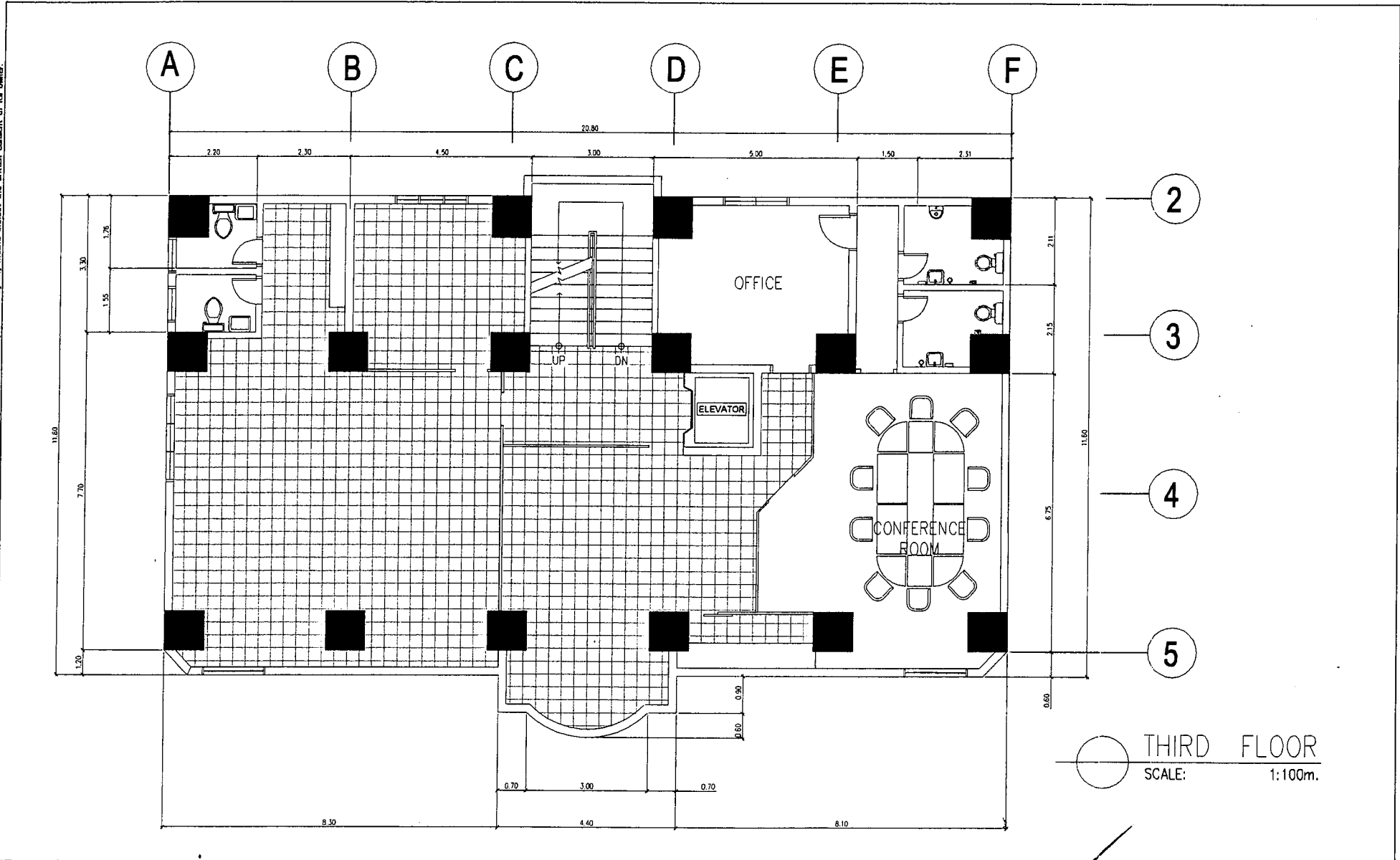

W CALAMBA WATER DISTRICT
 ENGINEERING DEPARTMENT
 PLANNING AND DESIGN DIVISION

LAKEVIEW SUBD., HALANG, CALAMBA CITY

PROJECT TITLE:
PROPOSED RENOVATION OF DILAPIDATED FLOOR TILES AT CWD BUILDING

LOCATION:

DRAWN BY: A. L. DEL PRADO
 DESIGNED BY: A. L. DEL PRADO
 CHECKED BY: ENGR. J. GILLERA
 APPROVED BY: MR. E. A. AGUILAR JR.

SHEET CONTENTS:

DATE: 07/24/2020

SHEET NO.

A-2

This design or drawing is the sole property of Calamba Water District. No part of this design or drawing may be reproduced or transmitted in any form or by any means without the written consent of its owner.

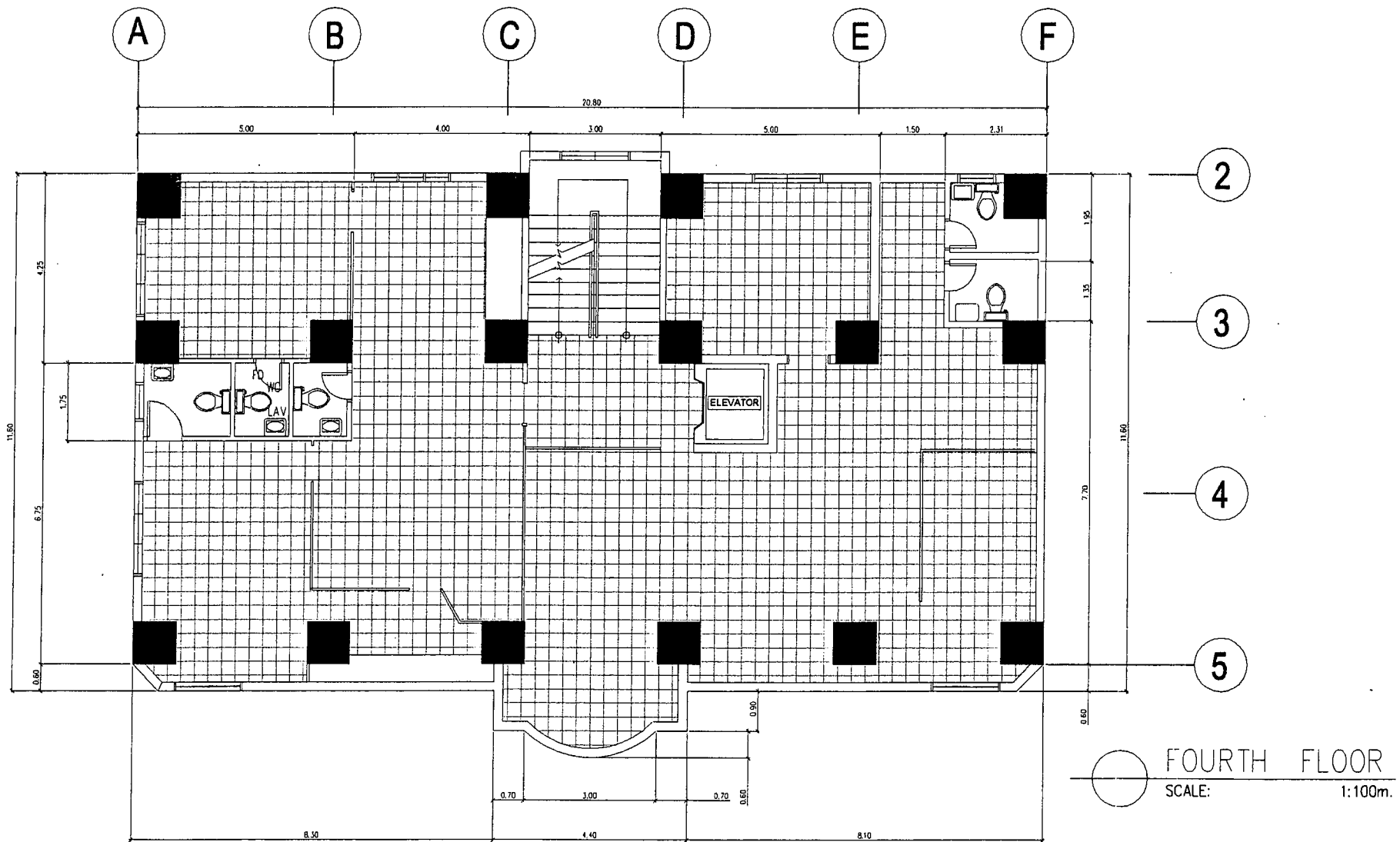

W CALAMBA WATER DISTRICT
 ENGINEERING DEPARTMENT
 PLANNING AND DESIGN DIVISION

LAKEVIEW SUBD., HALANG, CALAMBA CITY

PROJECT TITLE:

PROPOSED RENOVATION OF DILAPIDATED FLOOR TILES AT CWD BUILDING

LOCATION:

DRAWN BY: A. L. DEL PRADO

DESIGNED BY: A. L. DEL PRADO

CHECKED BY: ENGR. J. GILLERA

APPROVED BY: MR. E. A. AGUILAR JR.

SHEET CONTENTS:

DATE: 07/24/2020

SHEET NO.

A-3